

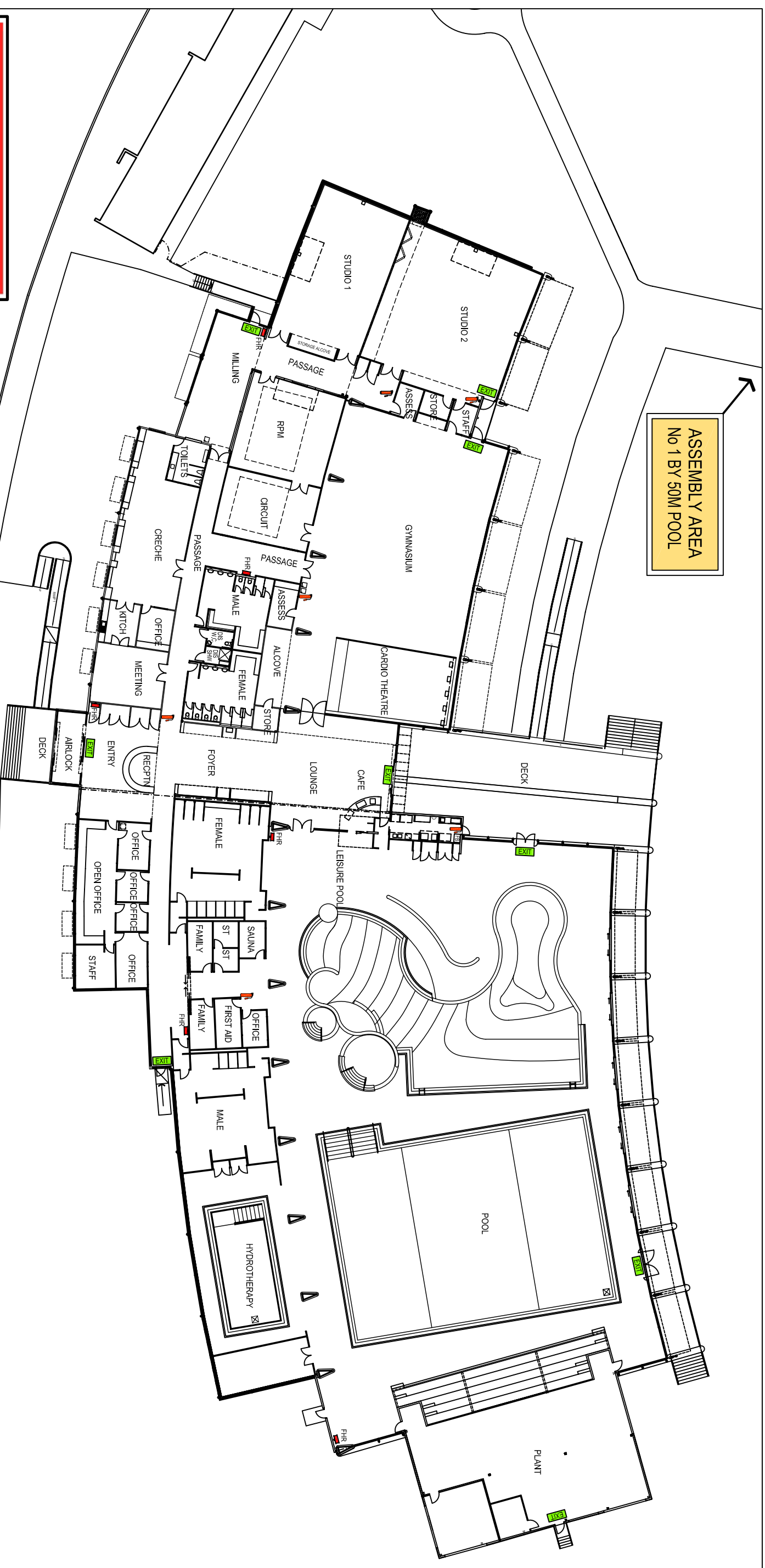





ASSEMBLY AREA  
No 1 BY 50M POOL

ASSEMBLY AREA No 2



### FIRE orders



- 1 Assist any person in immediate danger- if safe to do so 
- 2 Close the door 
- 3 Call the Fire Brigade on (insert Fire Brigade telephone no.) **000** 
- 4 Attack fire if safe to do so 
- 5 Evacuate to assembly area **Nominated Assembly Area** 
- 6 Remain at assembly area and ensure everybody is accounted for 

# AQUAMOVES EMERGENCY EVACUATION PLAN

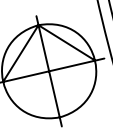
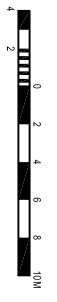

Prepared by:

Melbourne  
Shepparton



STEPHENSON + TURNER ARCHITECTS

RAY WHITE